

11000

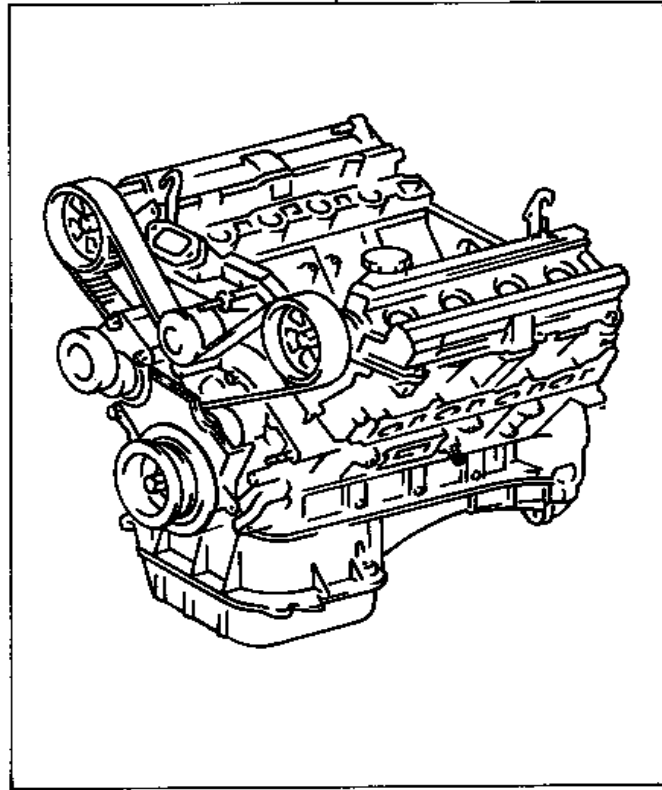

MA C101

11400

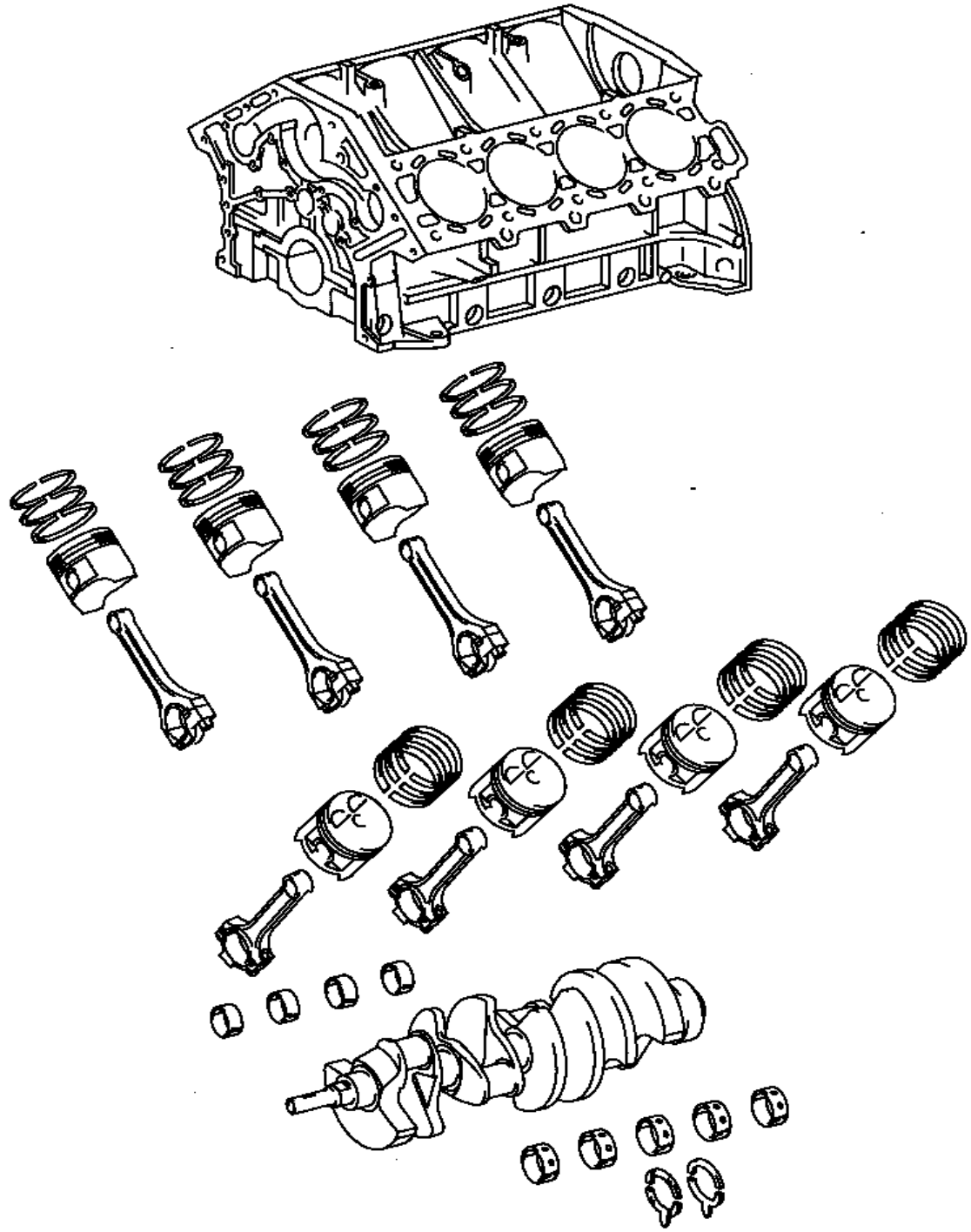

MAC102

04111

04112

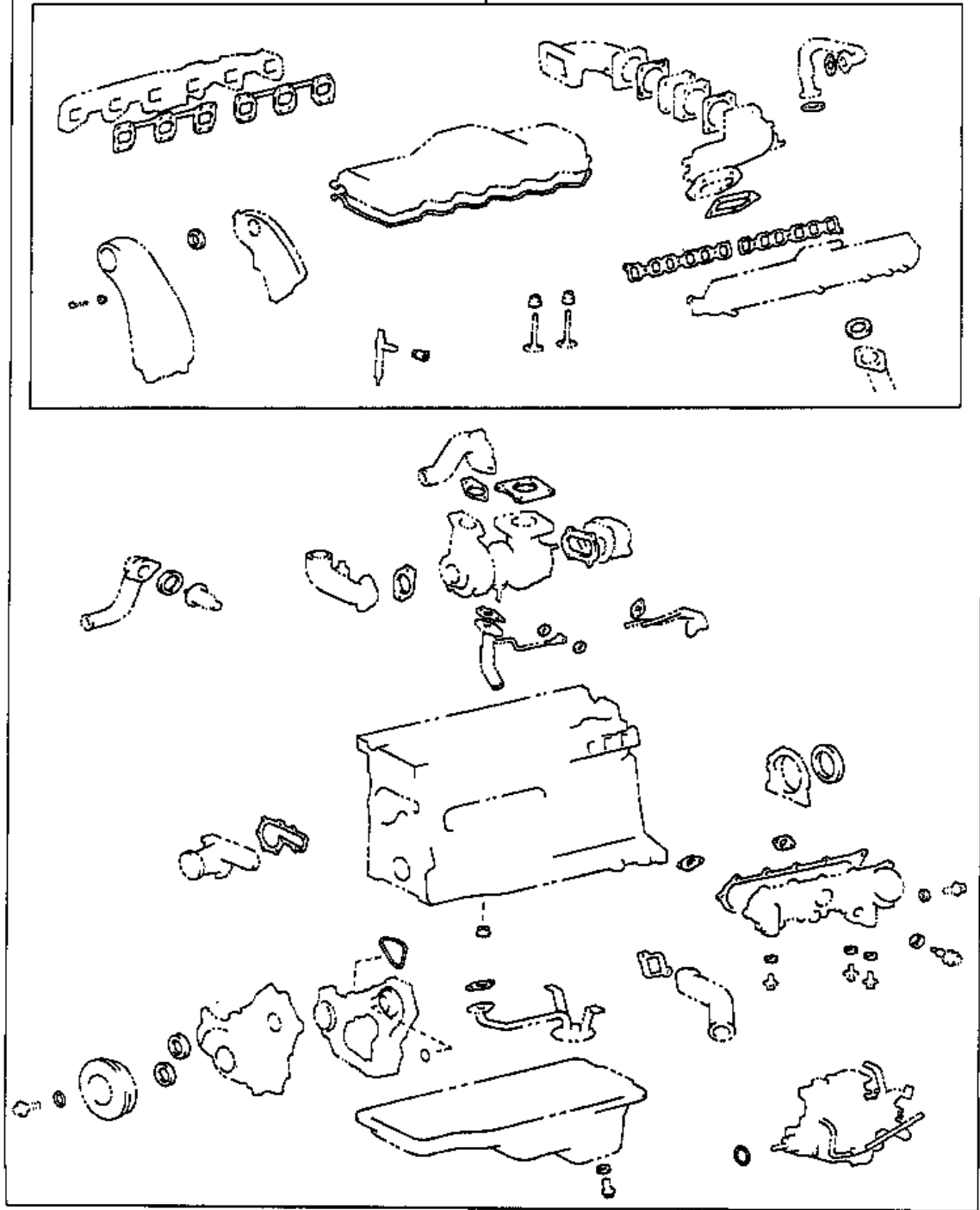

110980

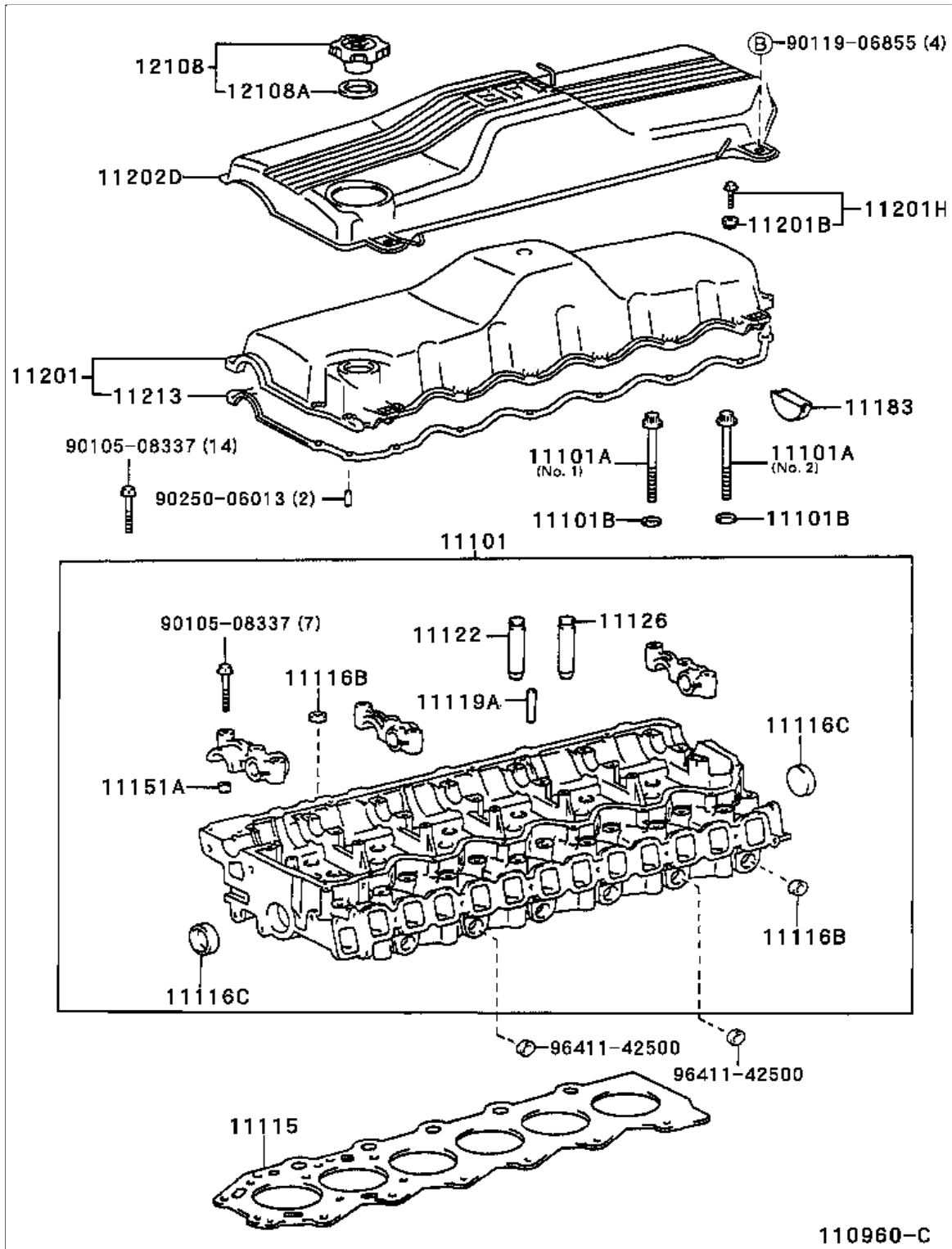

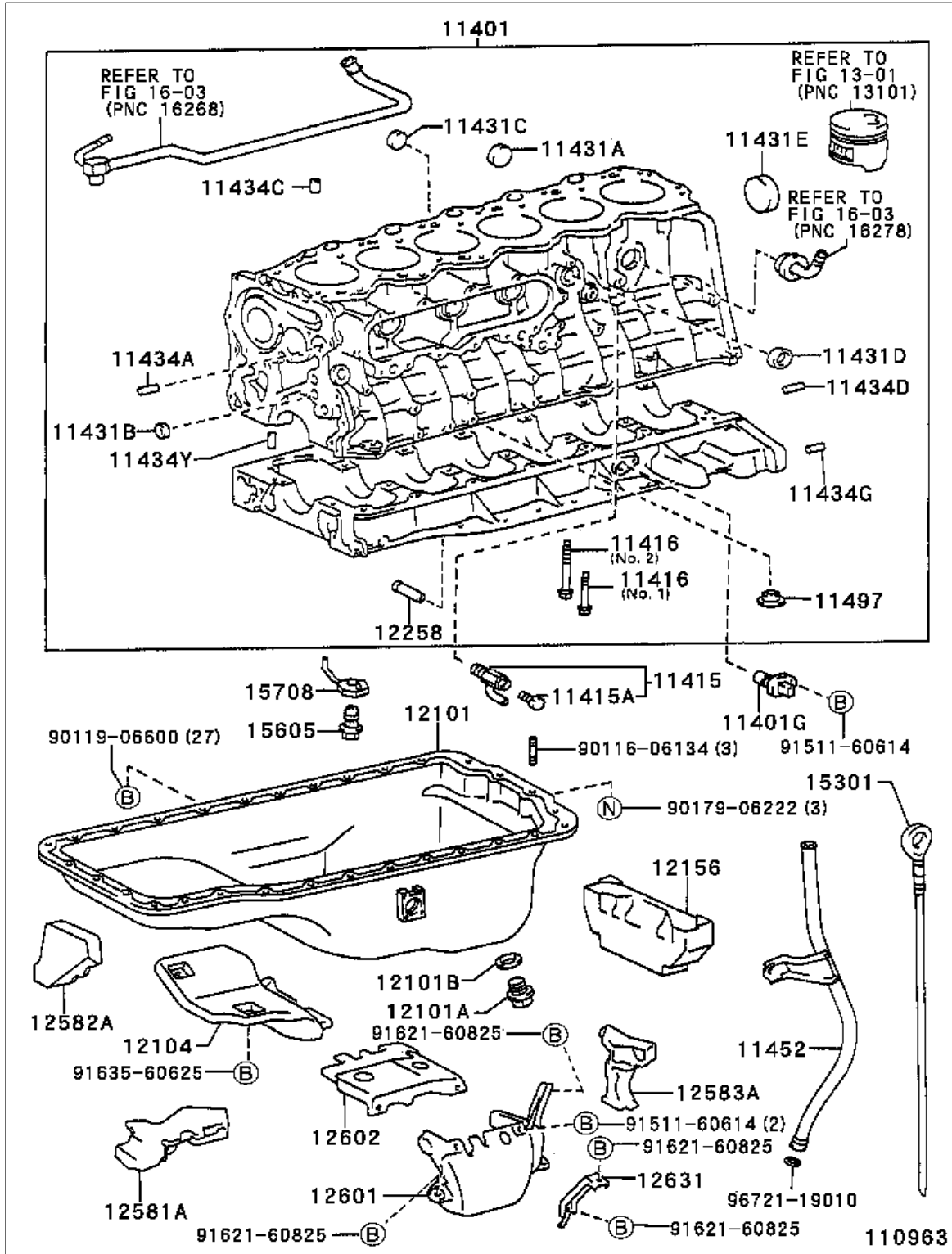

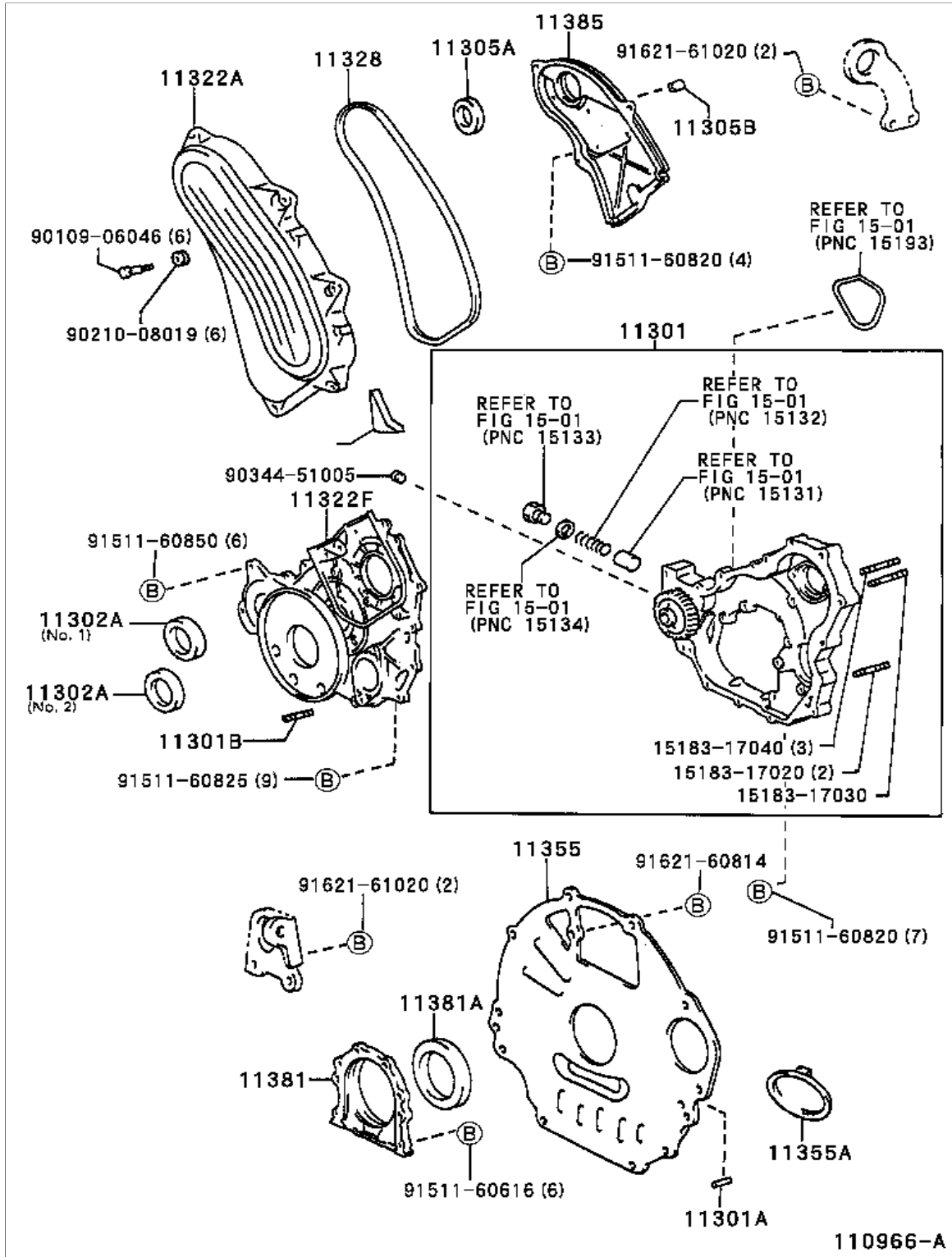

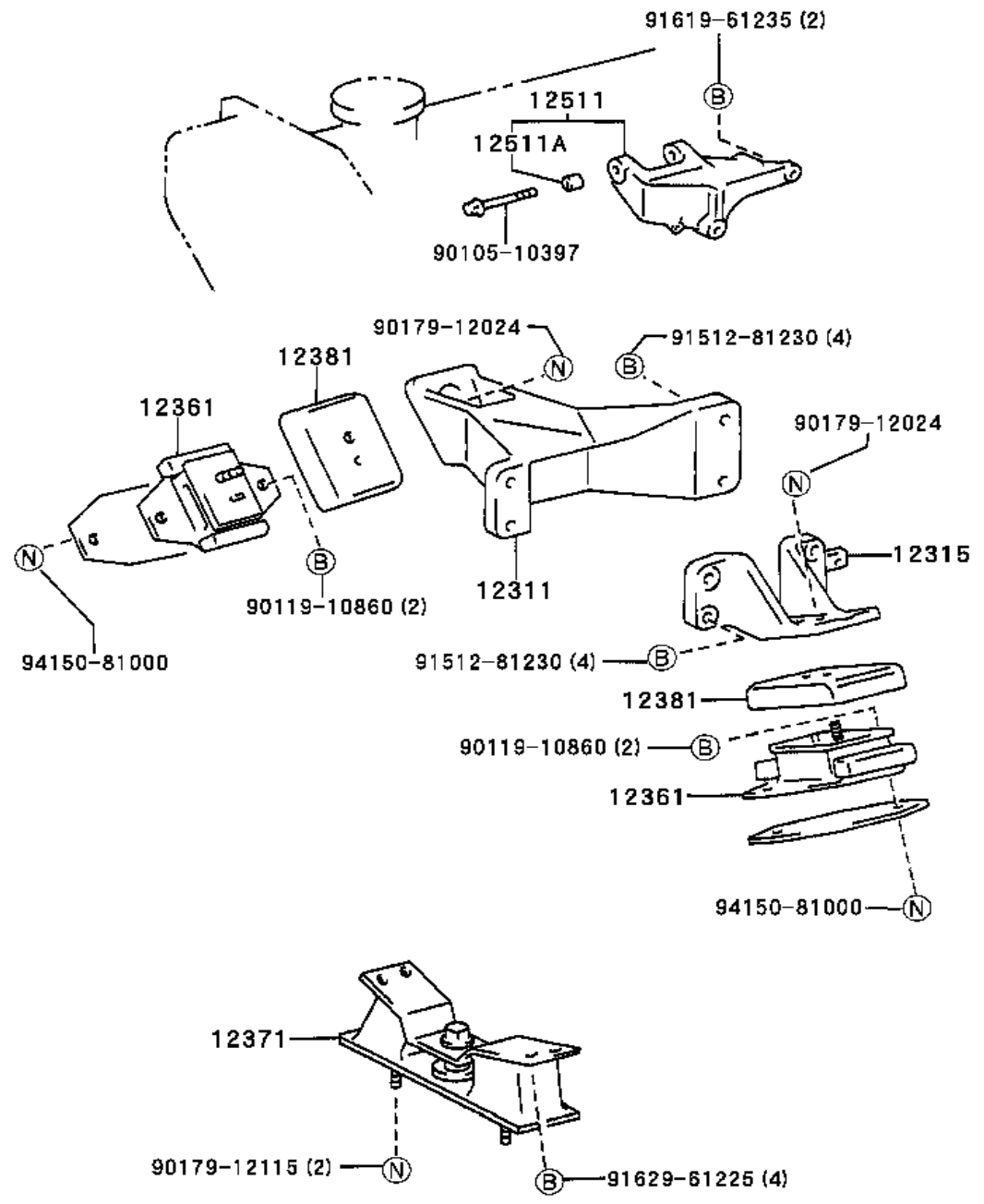



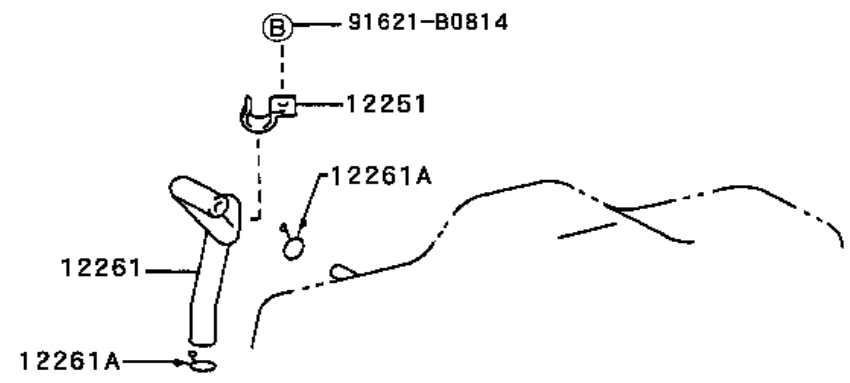

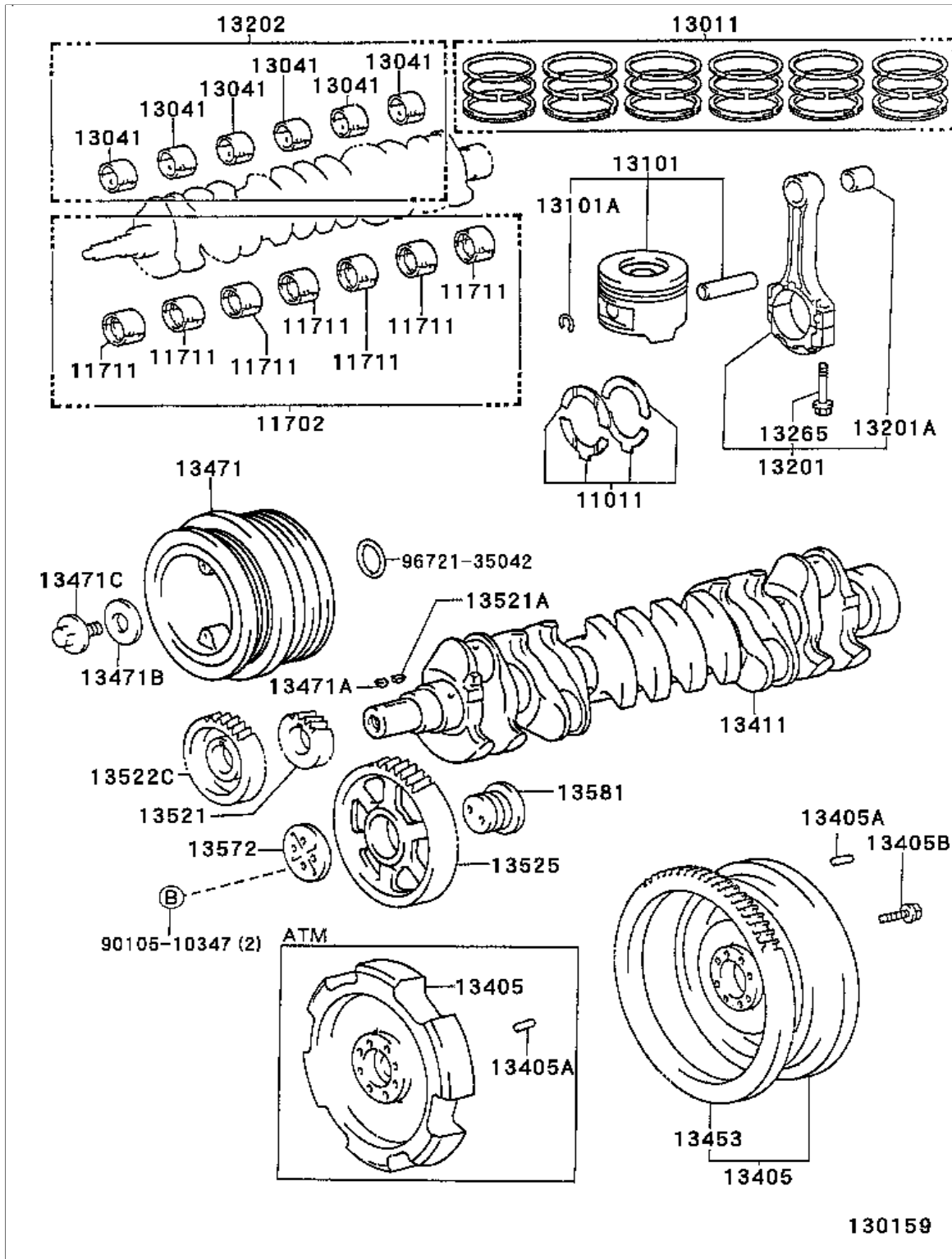

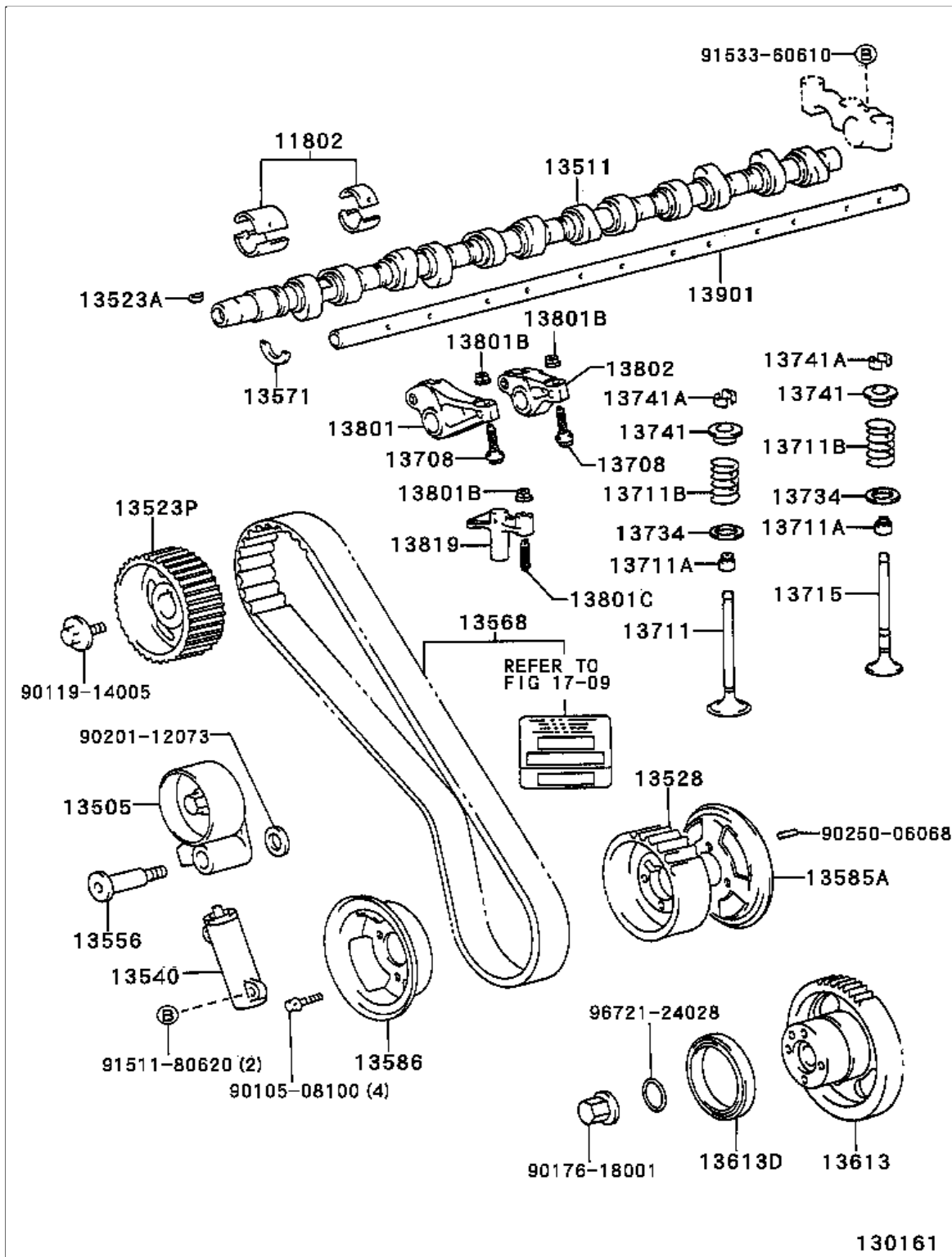

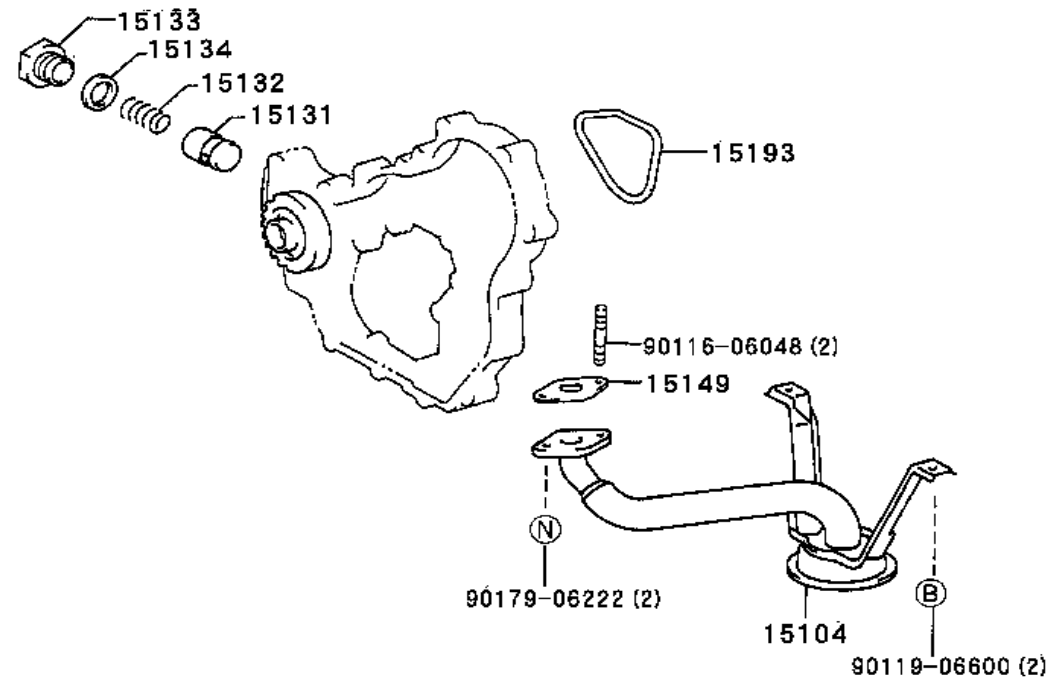

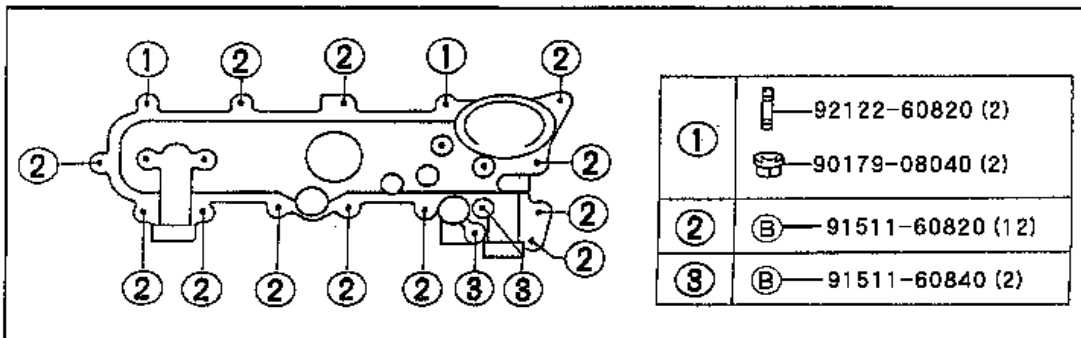
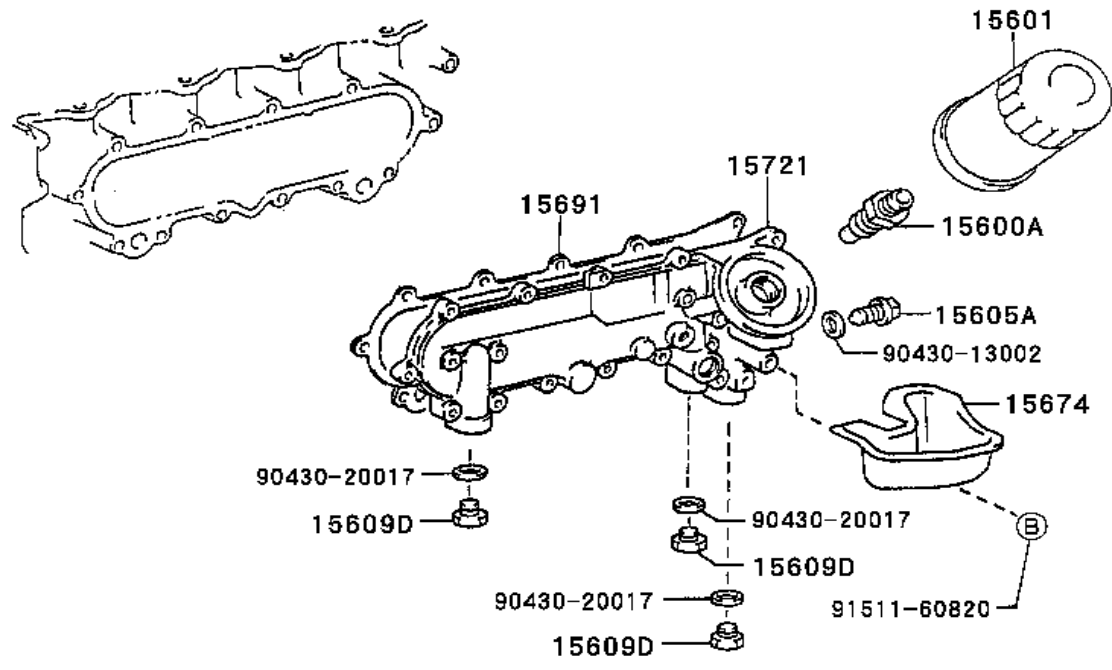

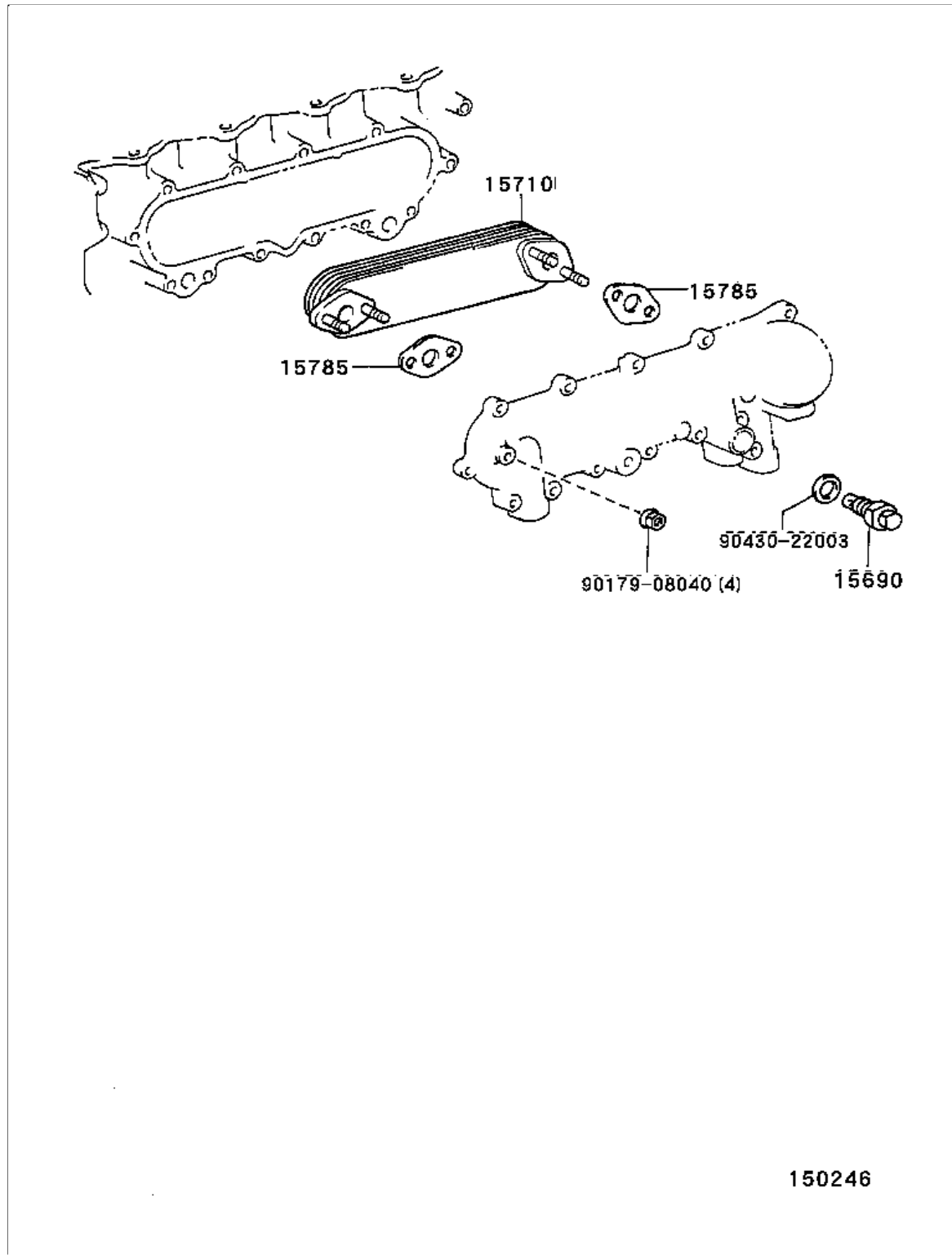

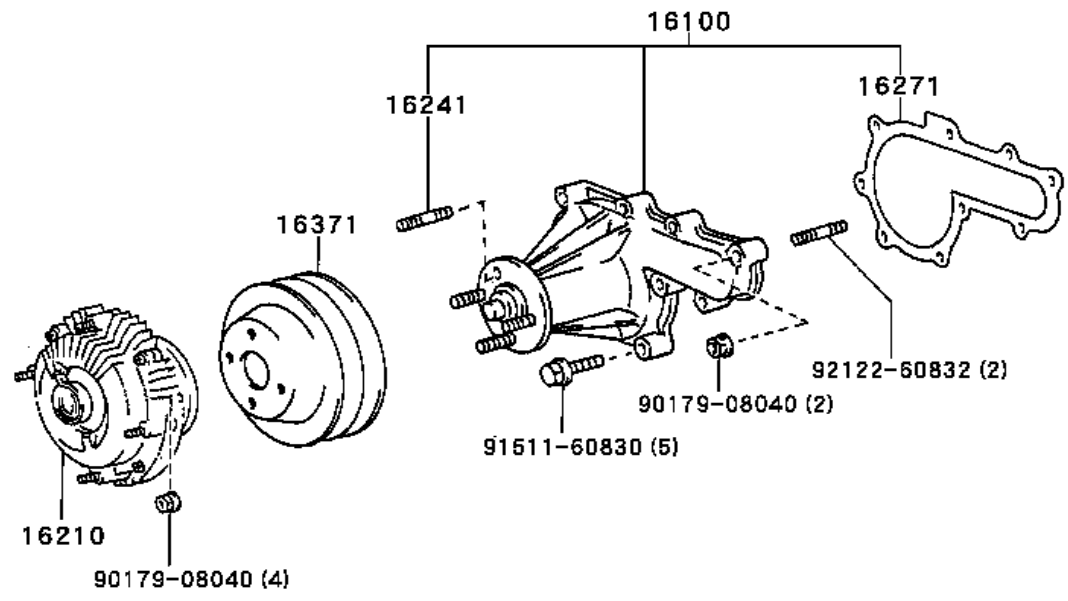

160617-A

ILLUST NO. 1 OF 2

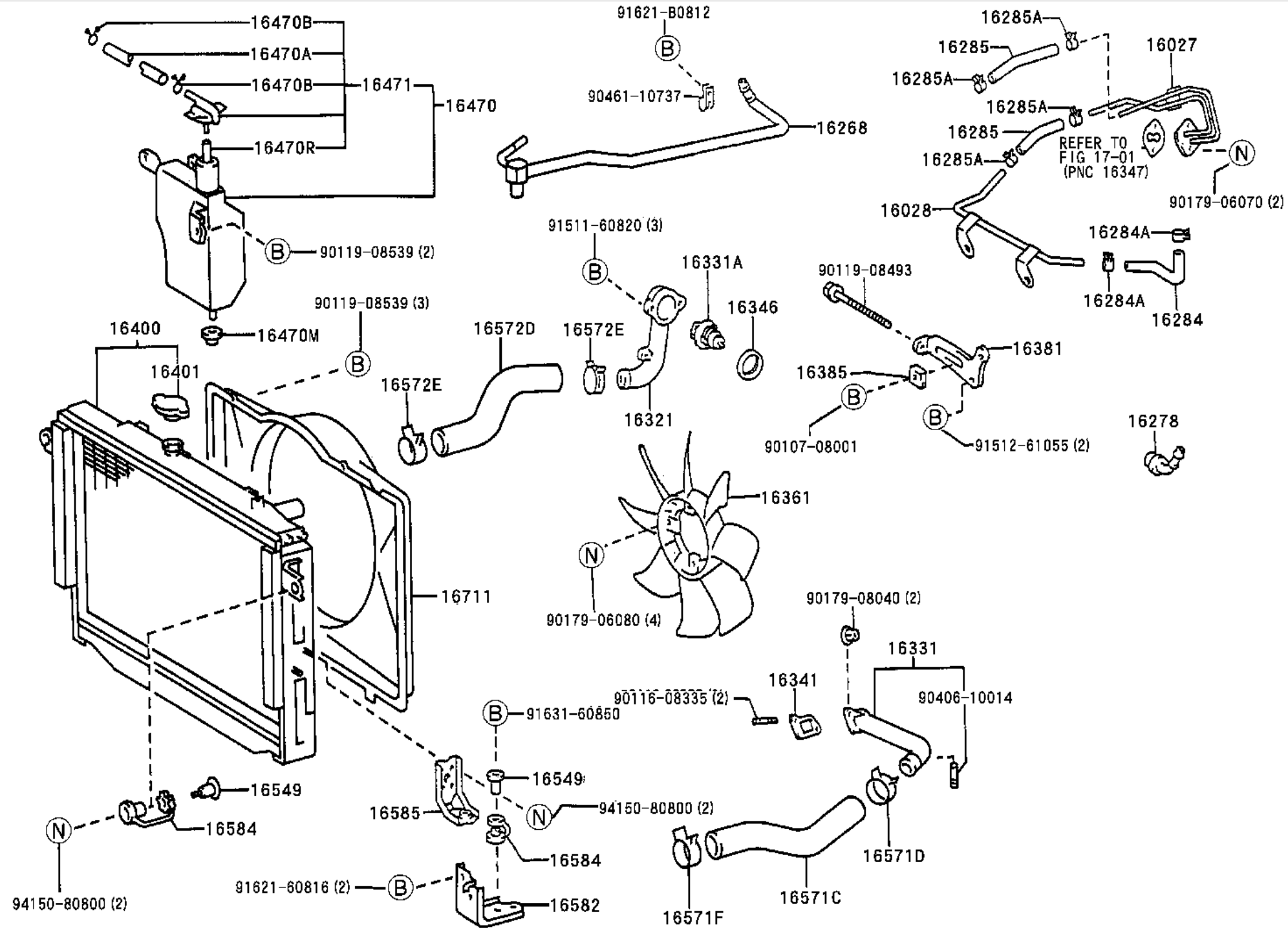



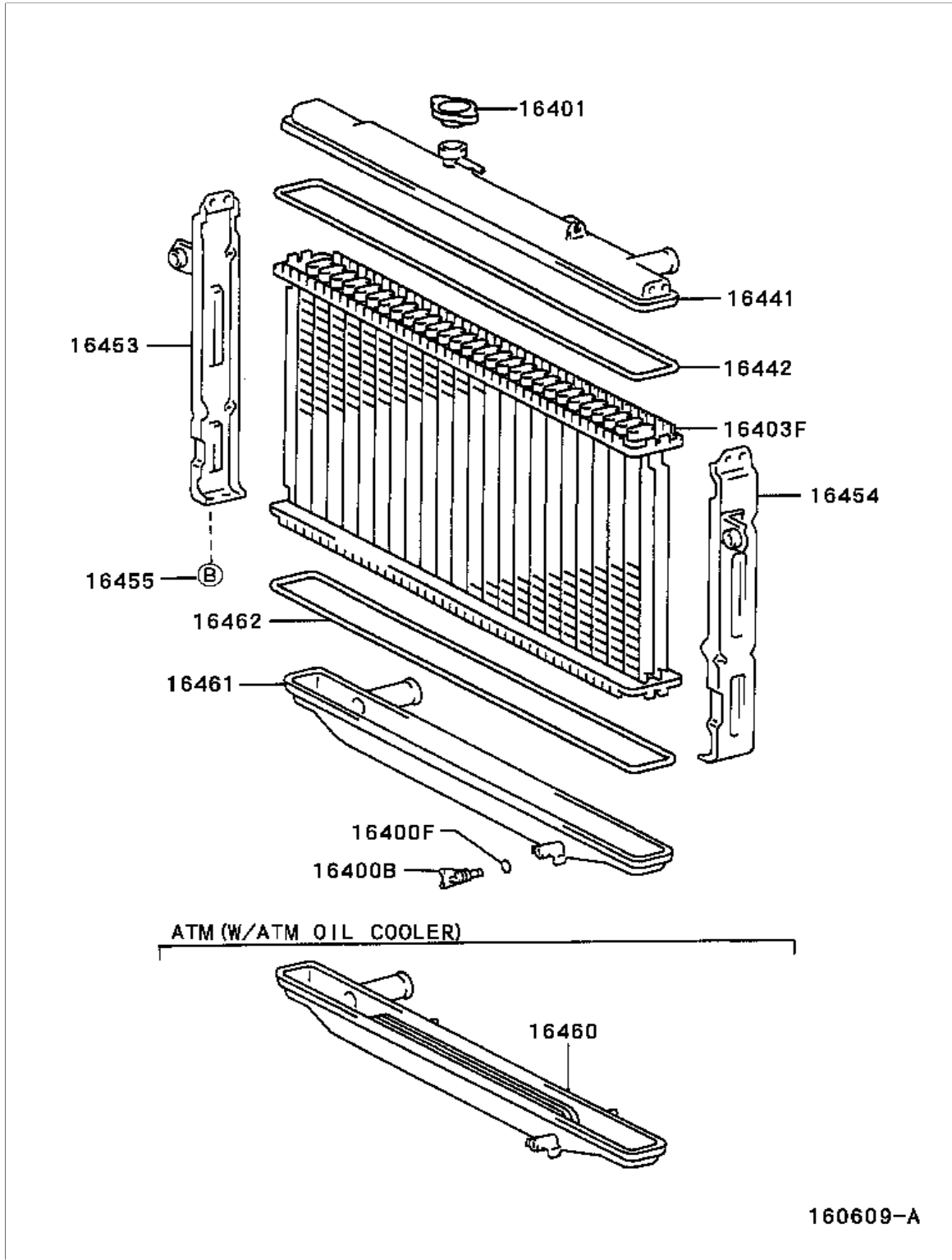

**2UZFE**

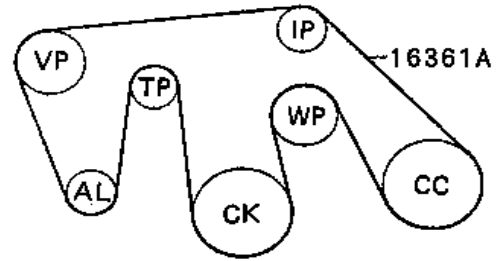

**1HDFTE**

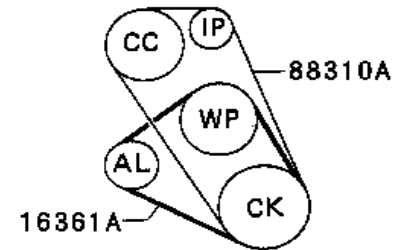

**1HDFTE (W/POWER HEATER)**

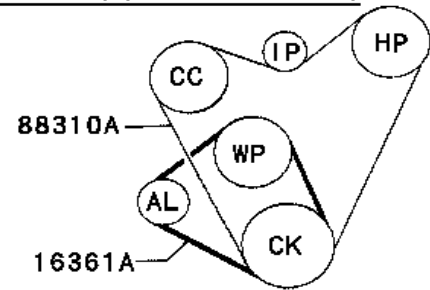

**1HDFTE (L/AIR CONDITIONER & W/POWER HEATER)**

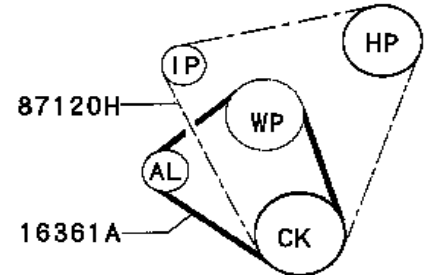

AL: Alternator  
CC: Cooler Compressor  
CK: Crankshaft  
HP: Heater Pulley  
IP: Idle Pulley  
TP: Tension Pulley  
VP: Vane Pump  
WP: Water Pump

ILLUST NO. 1 OF 2

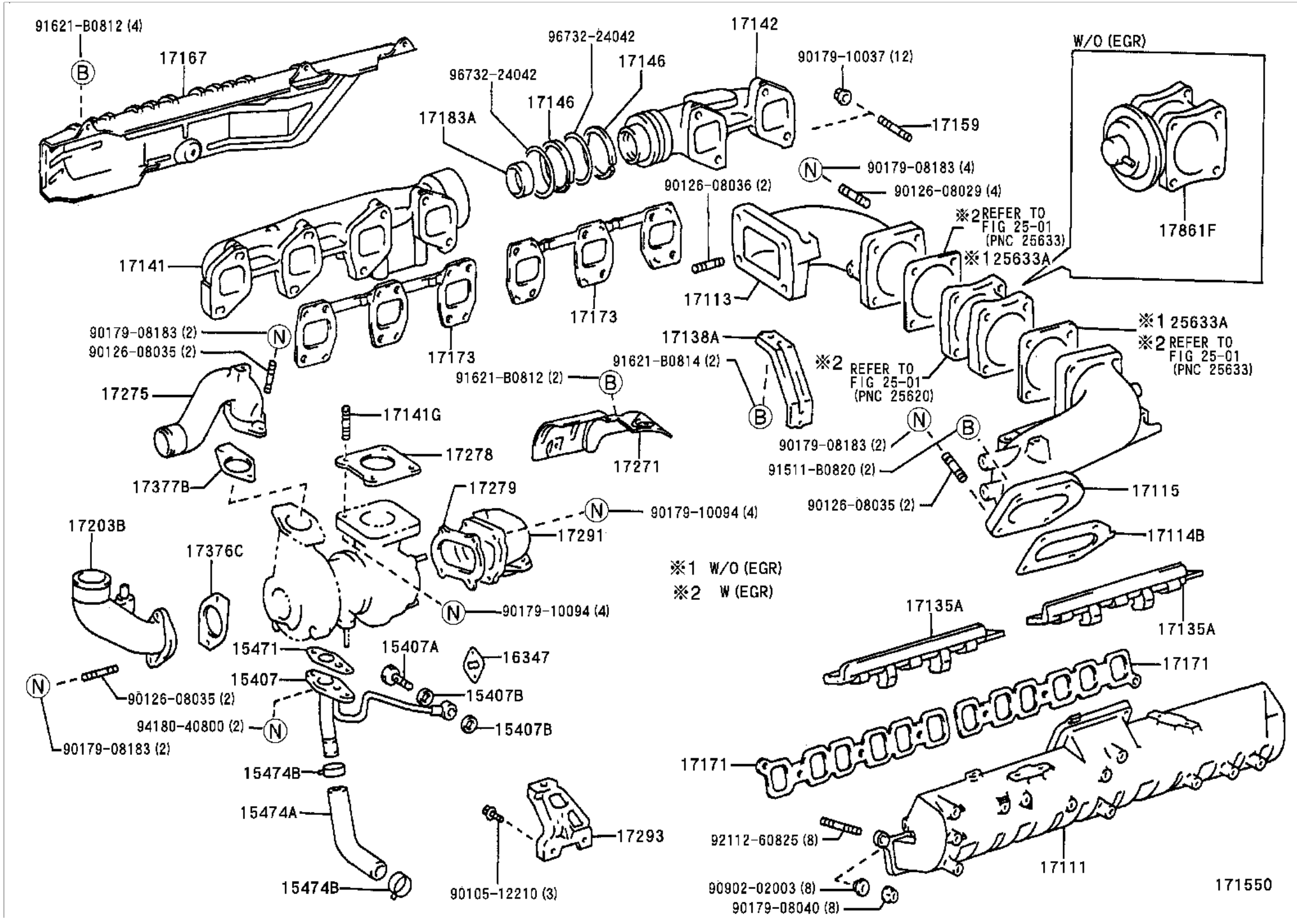

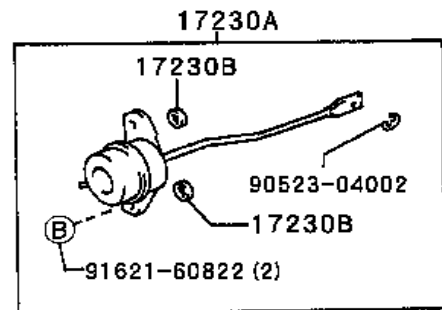
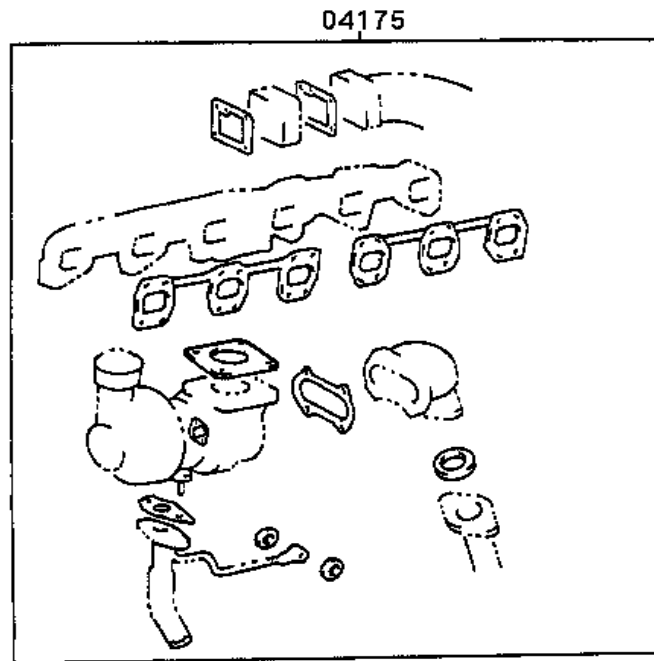
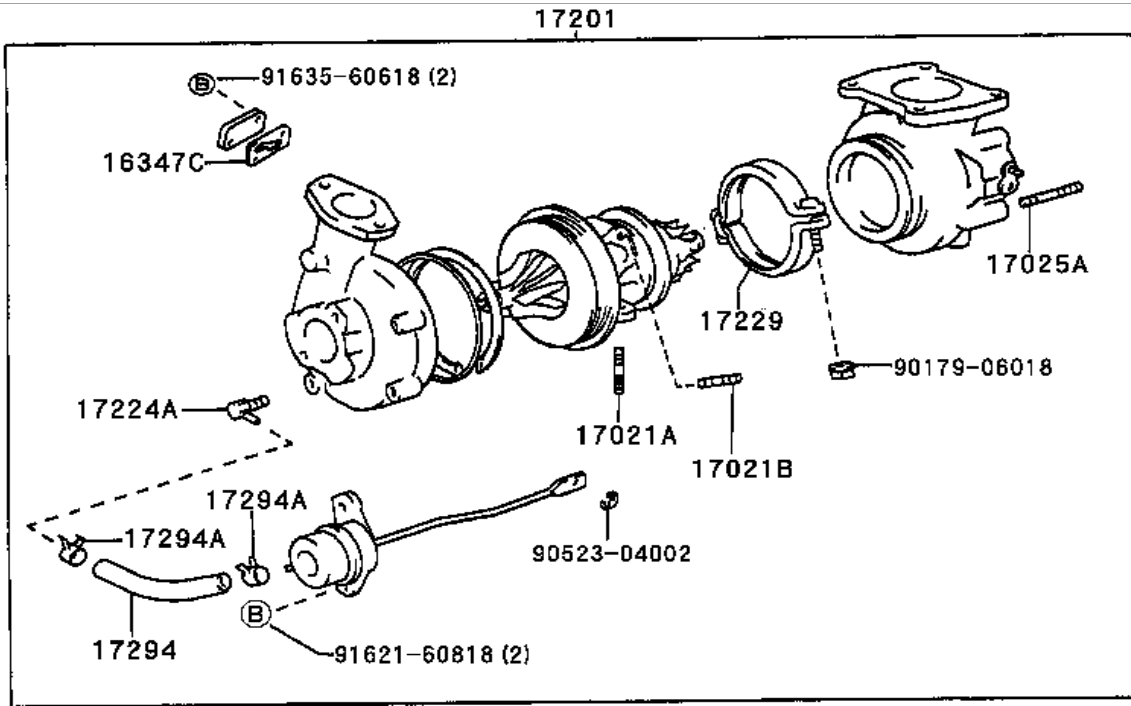

W/O (CONVERTER)

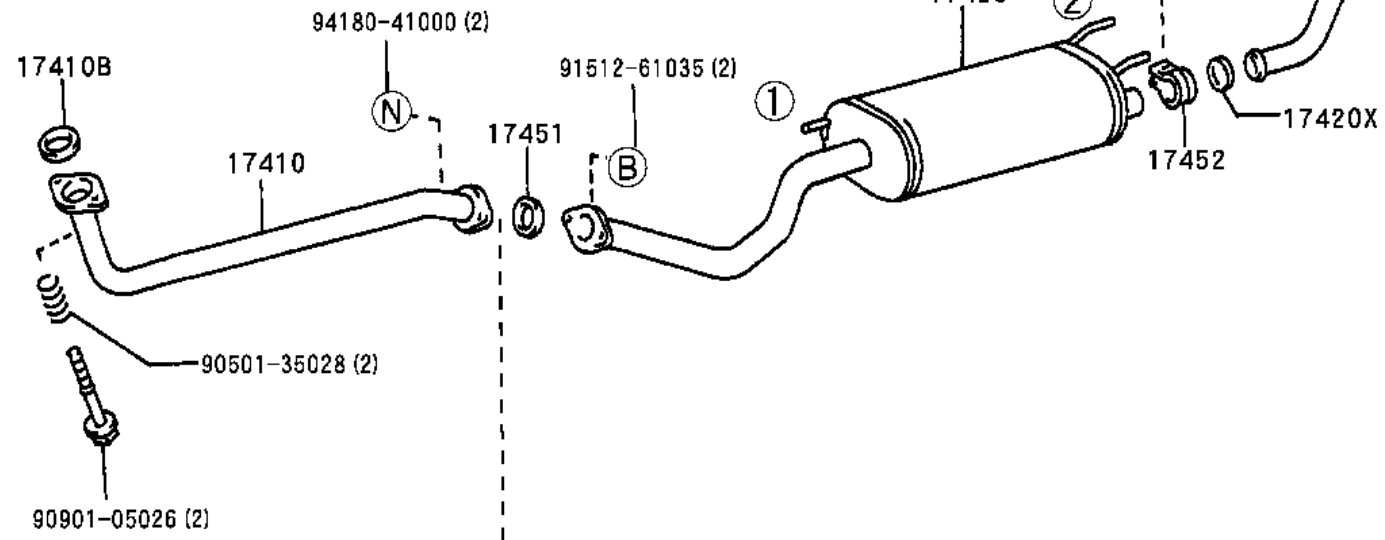

W (CONVERTER)

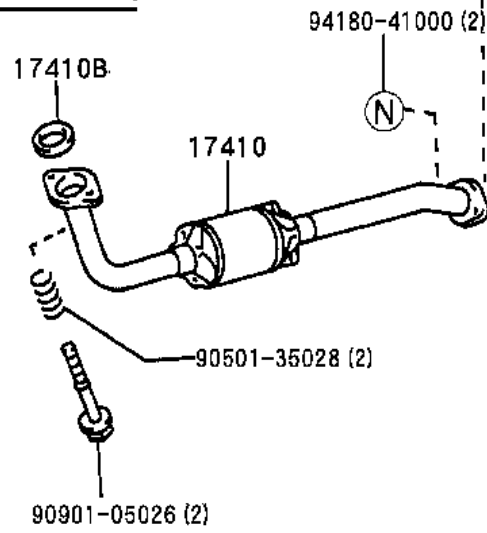

①	②	③	④
17562	17563A	17565A	17565A
	17563A		

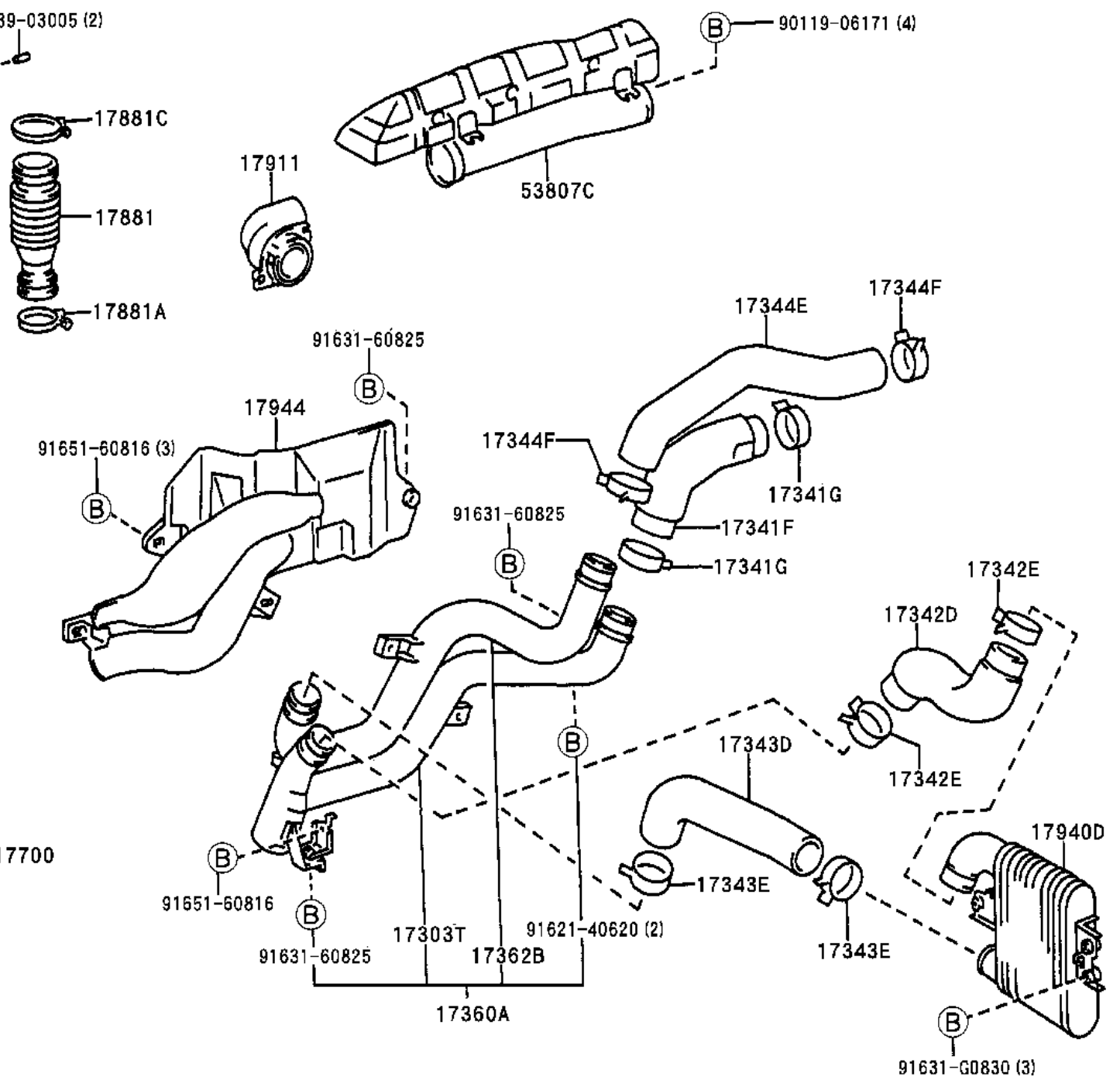
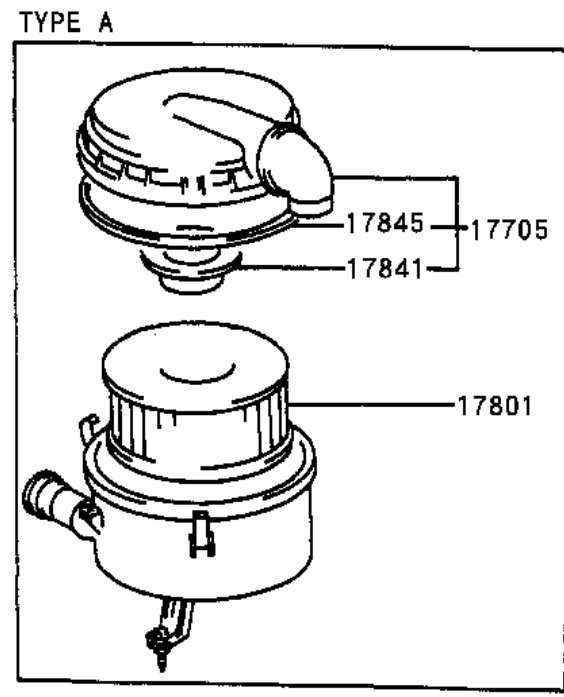
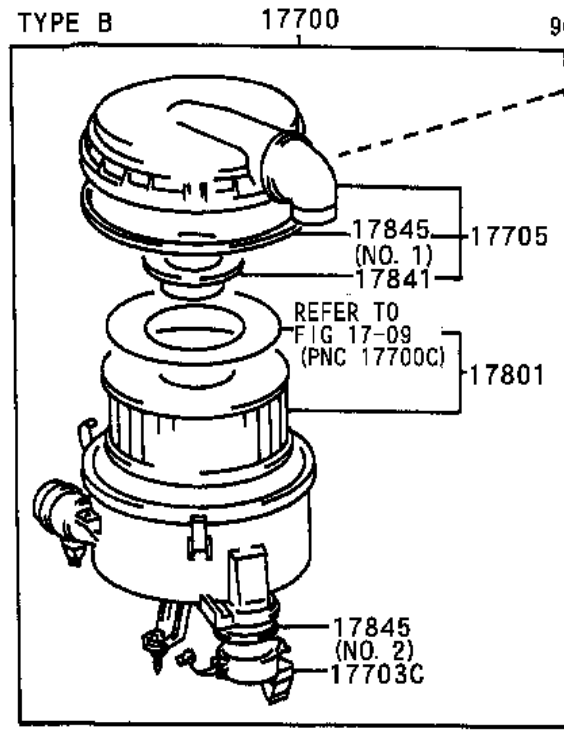

### Vacuum Hose Supply Method

Supply of Vacuum Hose is determined in length specified below.

Necessary Length	Part Number	Length available
Below 300 mm	90999-92002	300 mm
301 to 600 mm	90999-92003	600 mm
601 to 950 mm	90999-92004	950 mm
951 to 1300 mm	90999-92006	1300 mm
1301 to 1650 mm	90999-92007	1650 mm
1651 to 2600 mm	90999-92008	2600 mm

1. Actual replacement to vehicle could be made by cutting the hose into desired length.
2. Unlike the vacuum hose already installed in the vehicle, this replacement vacuum hose does not have the hose number printed on it. Accordingly, before installing this vacuum hose, write on it the same hose number as that written on the vacuum hose to be removed as shown below.

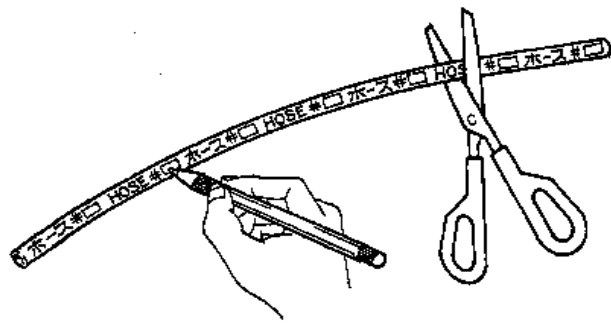
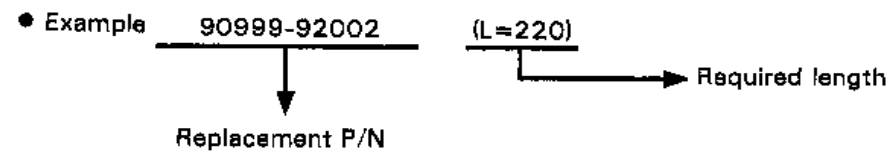

1. As hose is supplied in 300 mm length, cut off excess to meet desired length of 220 mm.
2. Using an oil-based marking pen or a ball-point pen, write the hose number at both ends of the hose, in accordance with the original hose number.

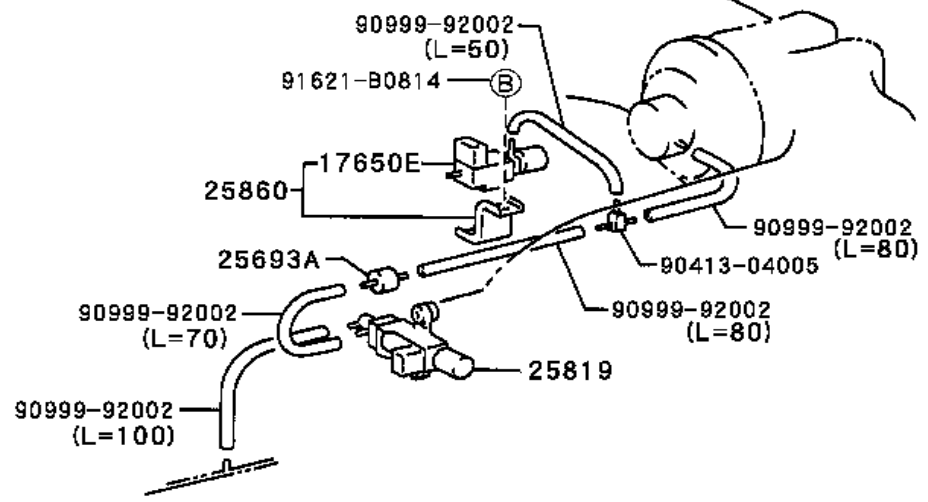
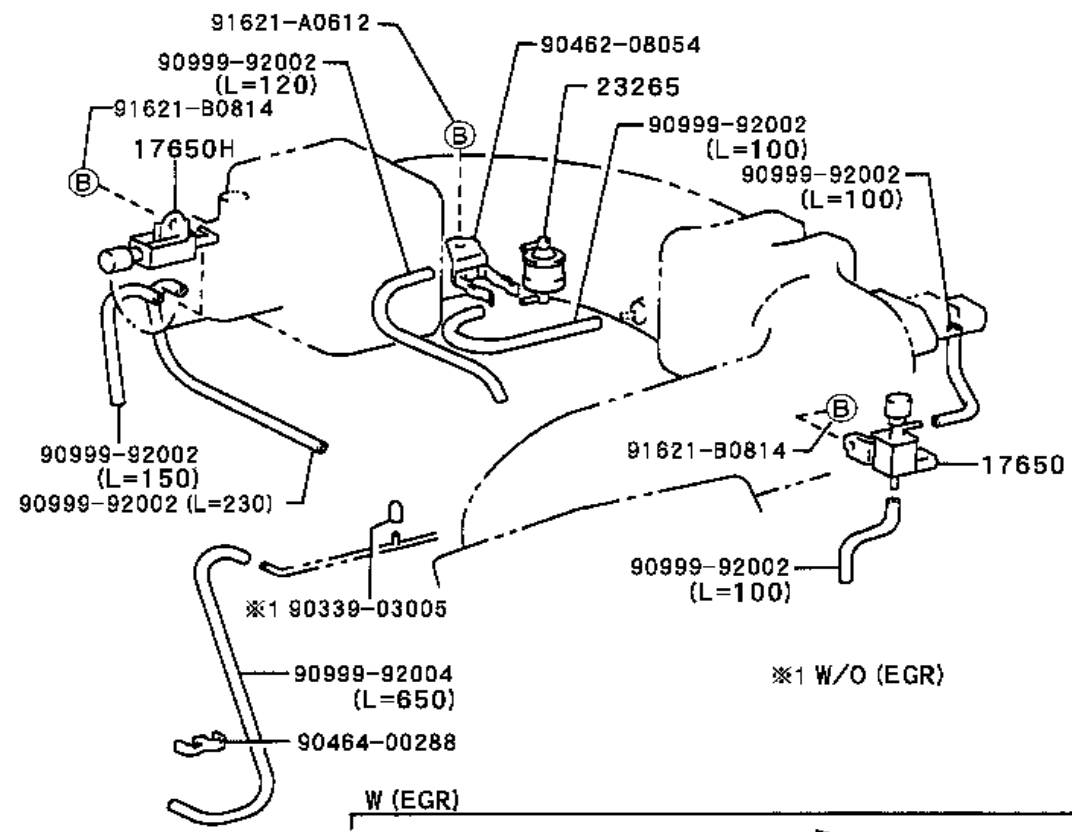



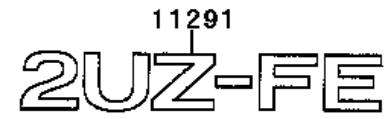
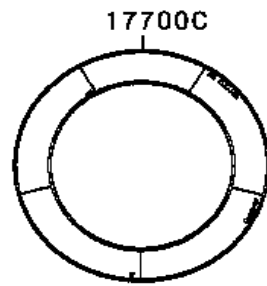
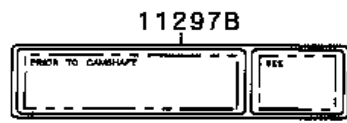
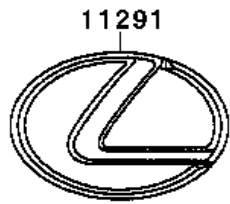
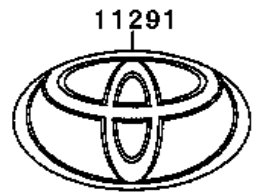
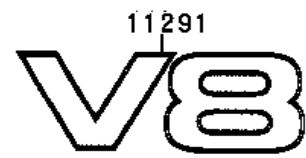
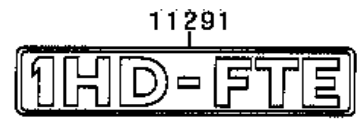
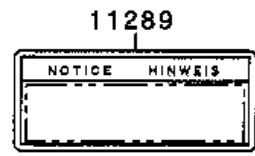

HOOD

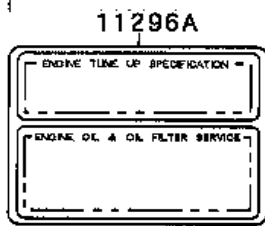

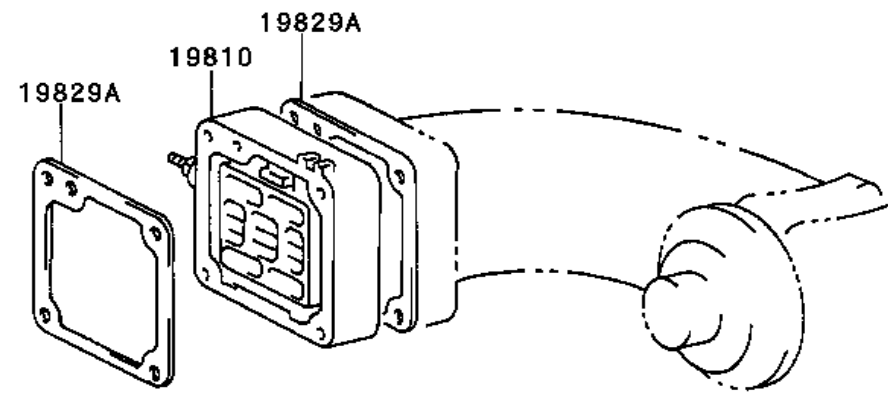

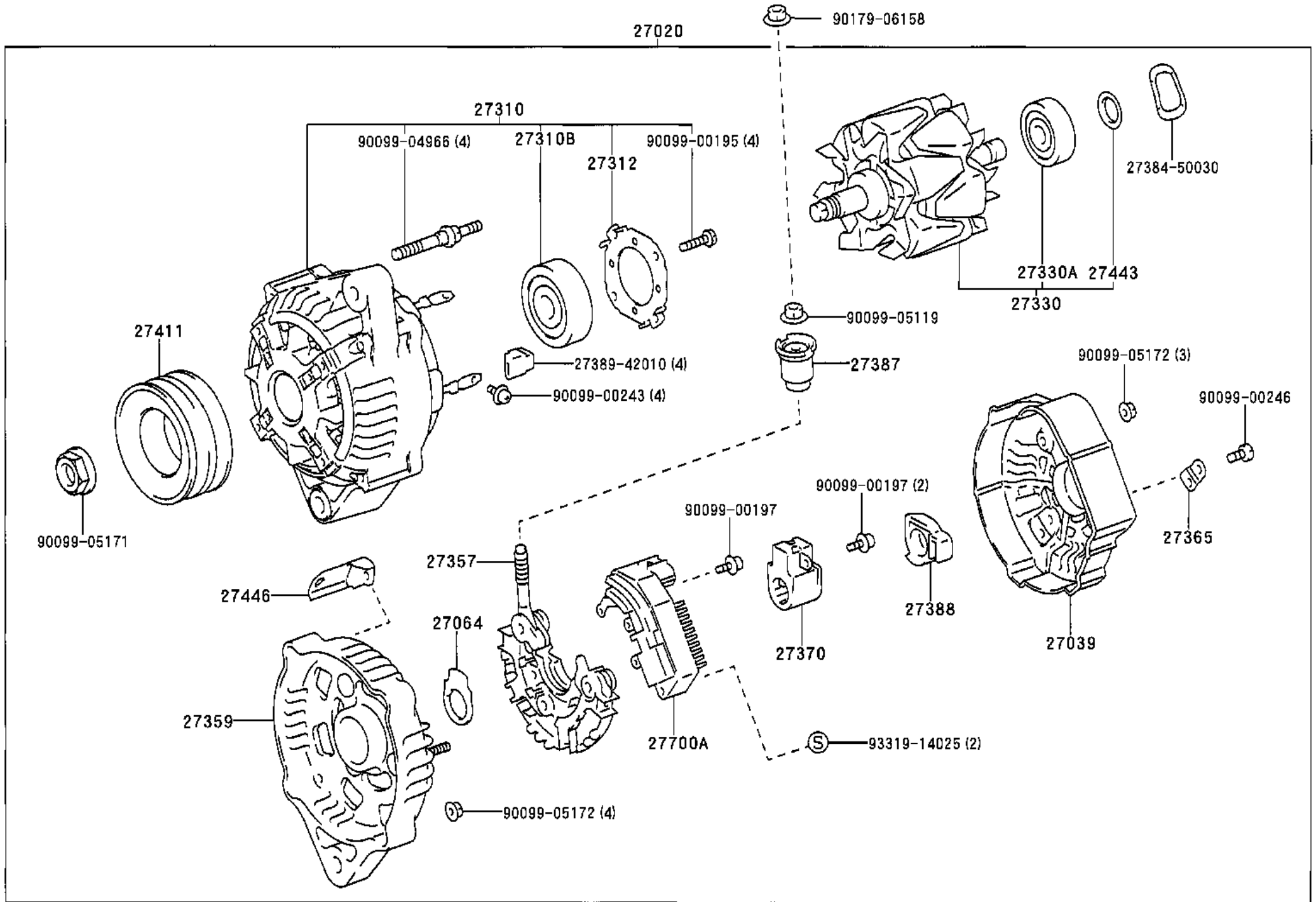

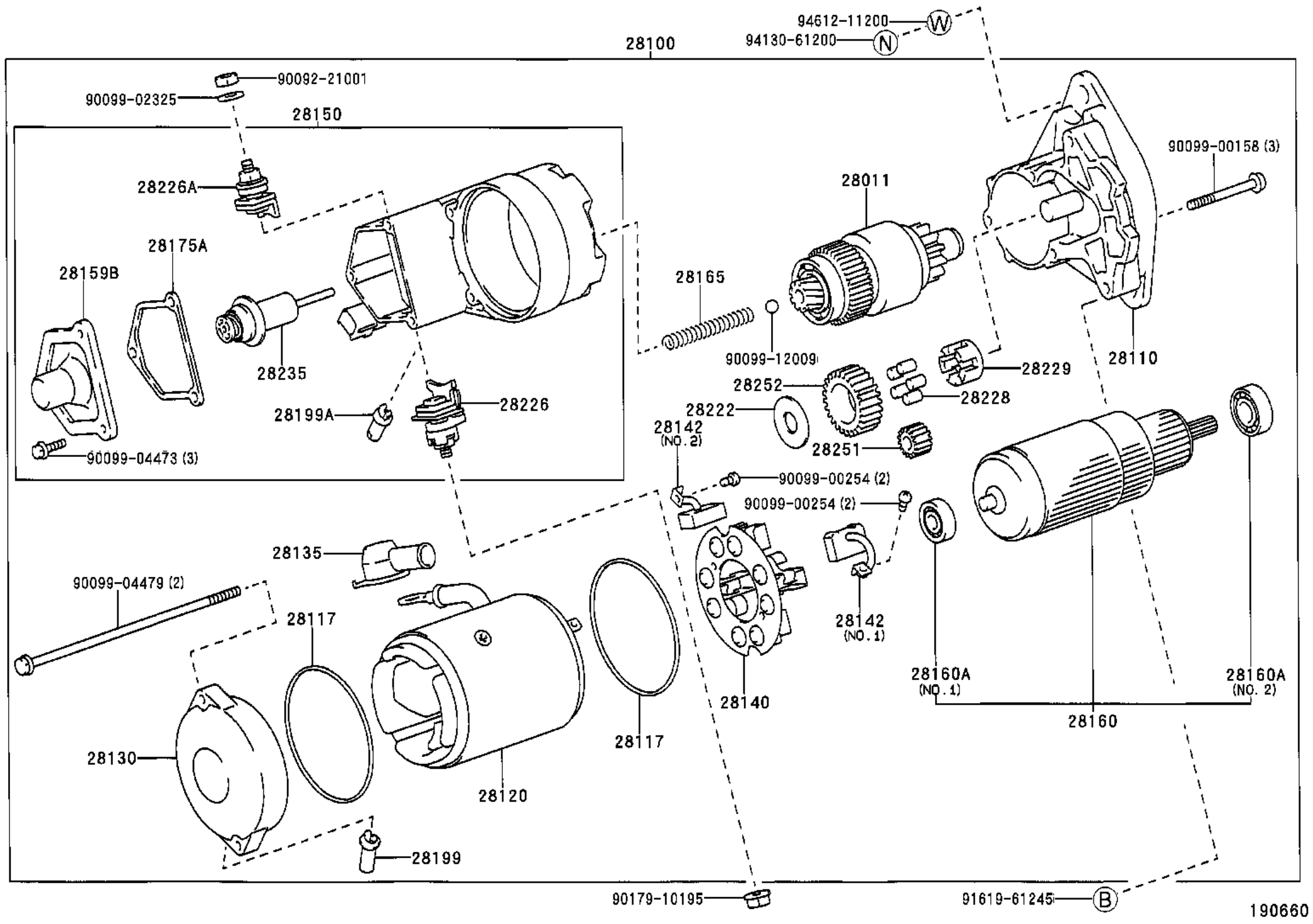

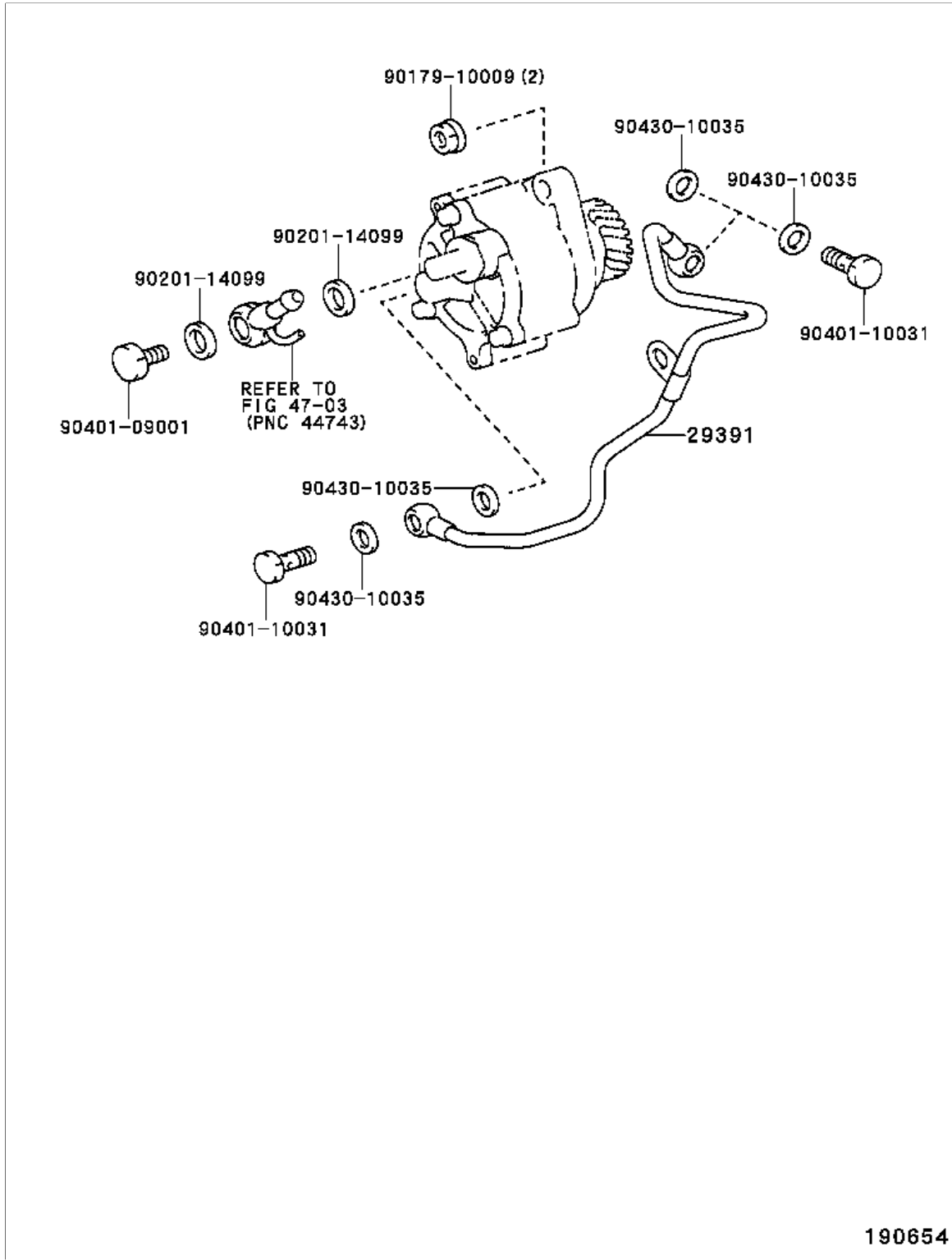

ILLUST NO. 2 OF 2

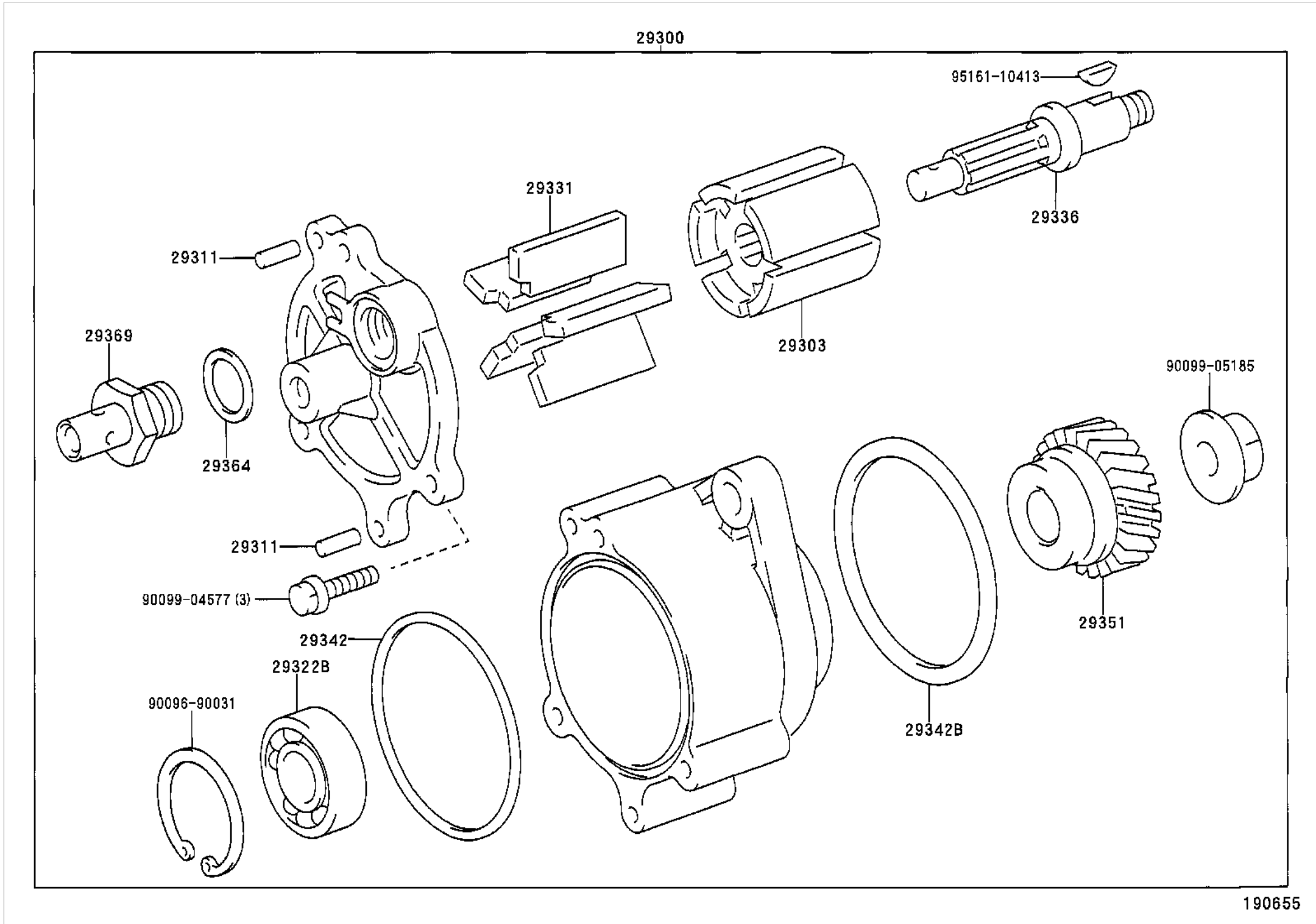

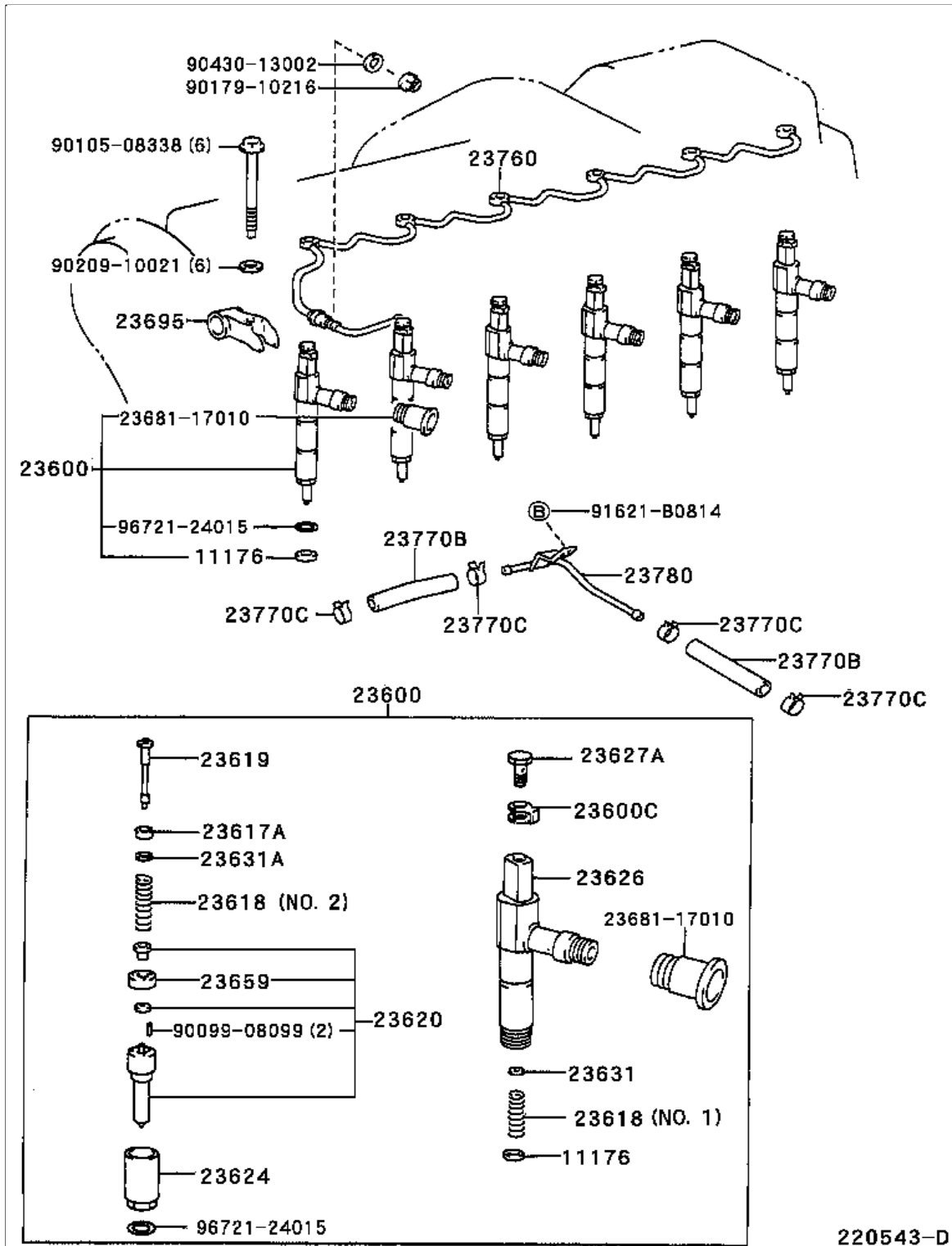

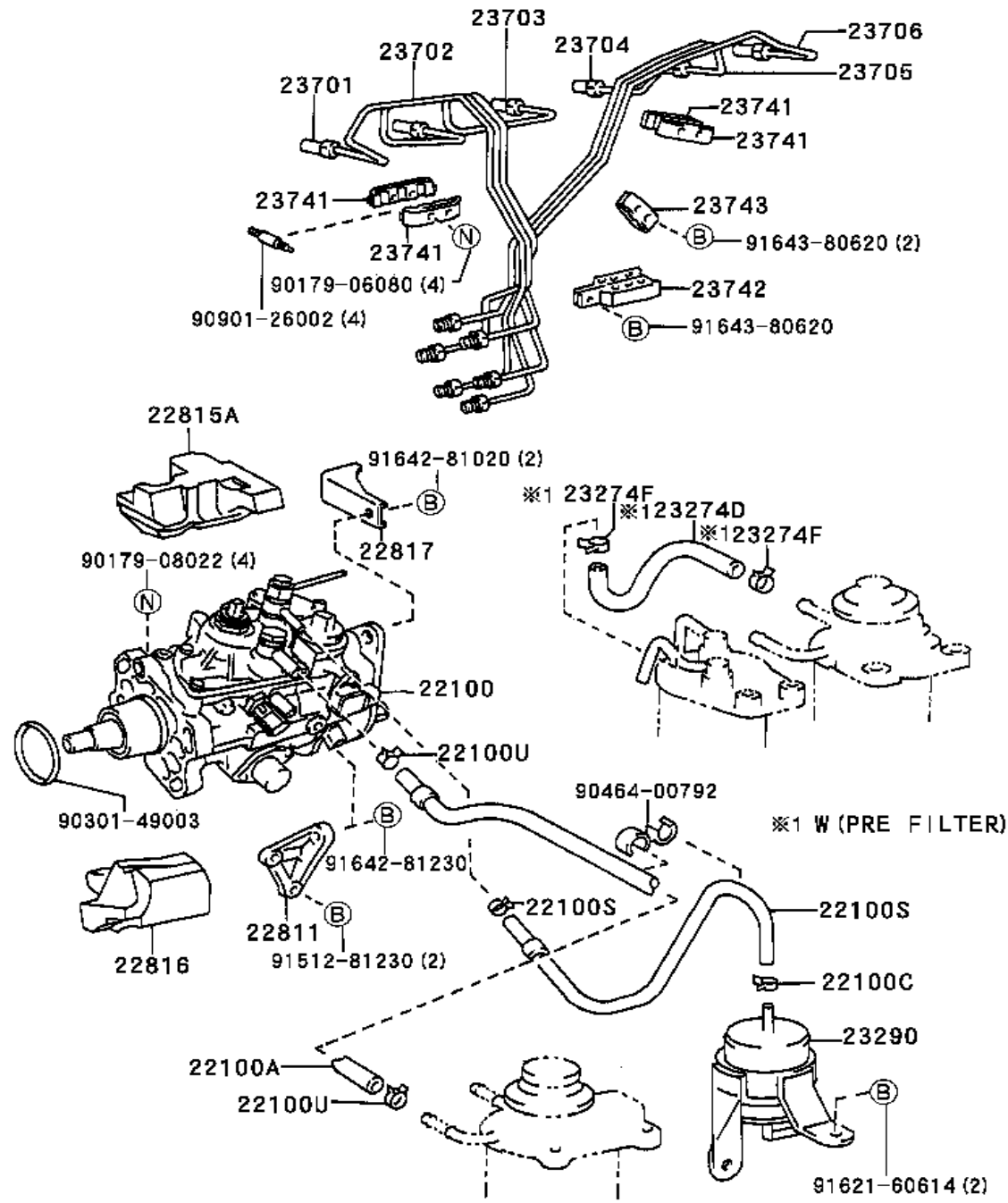



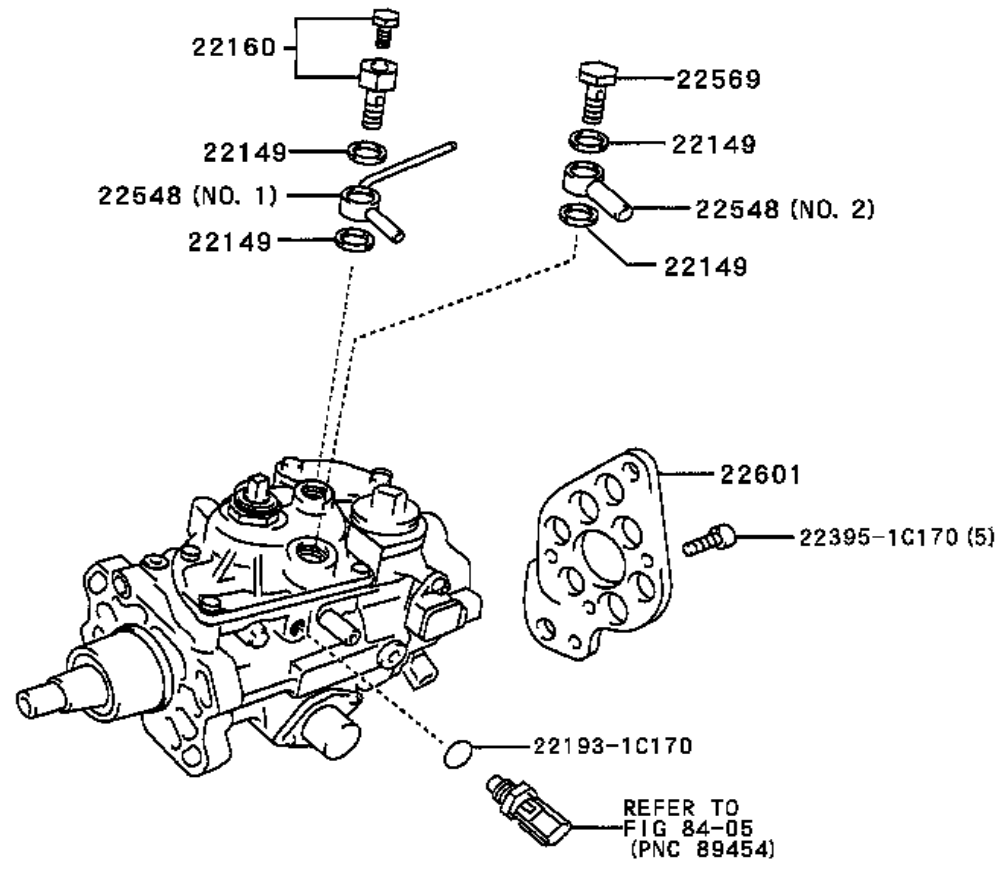

220549

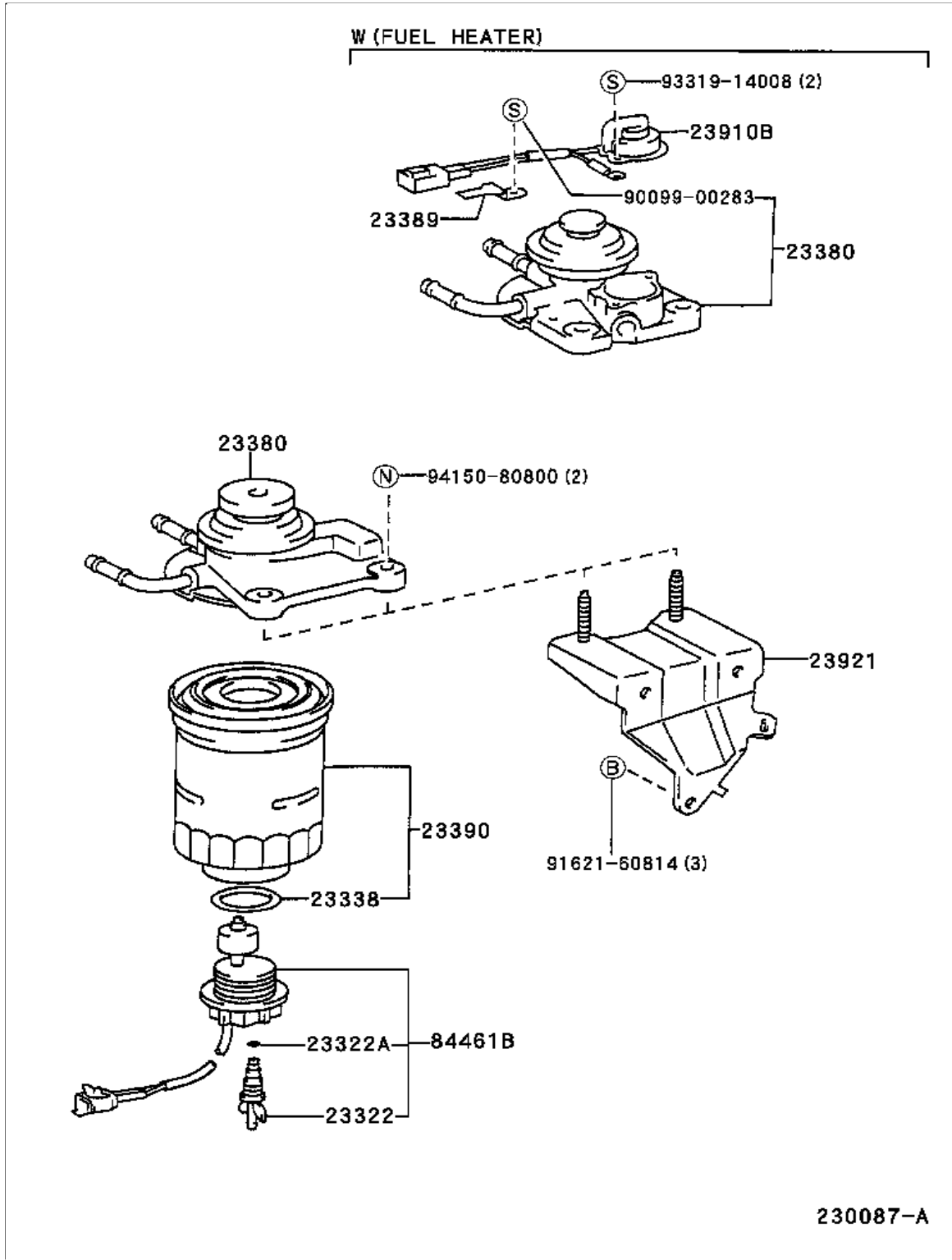

W (PRE FILTER)

